

Courtroom A

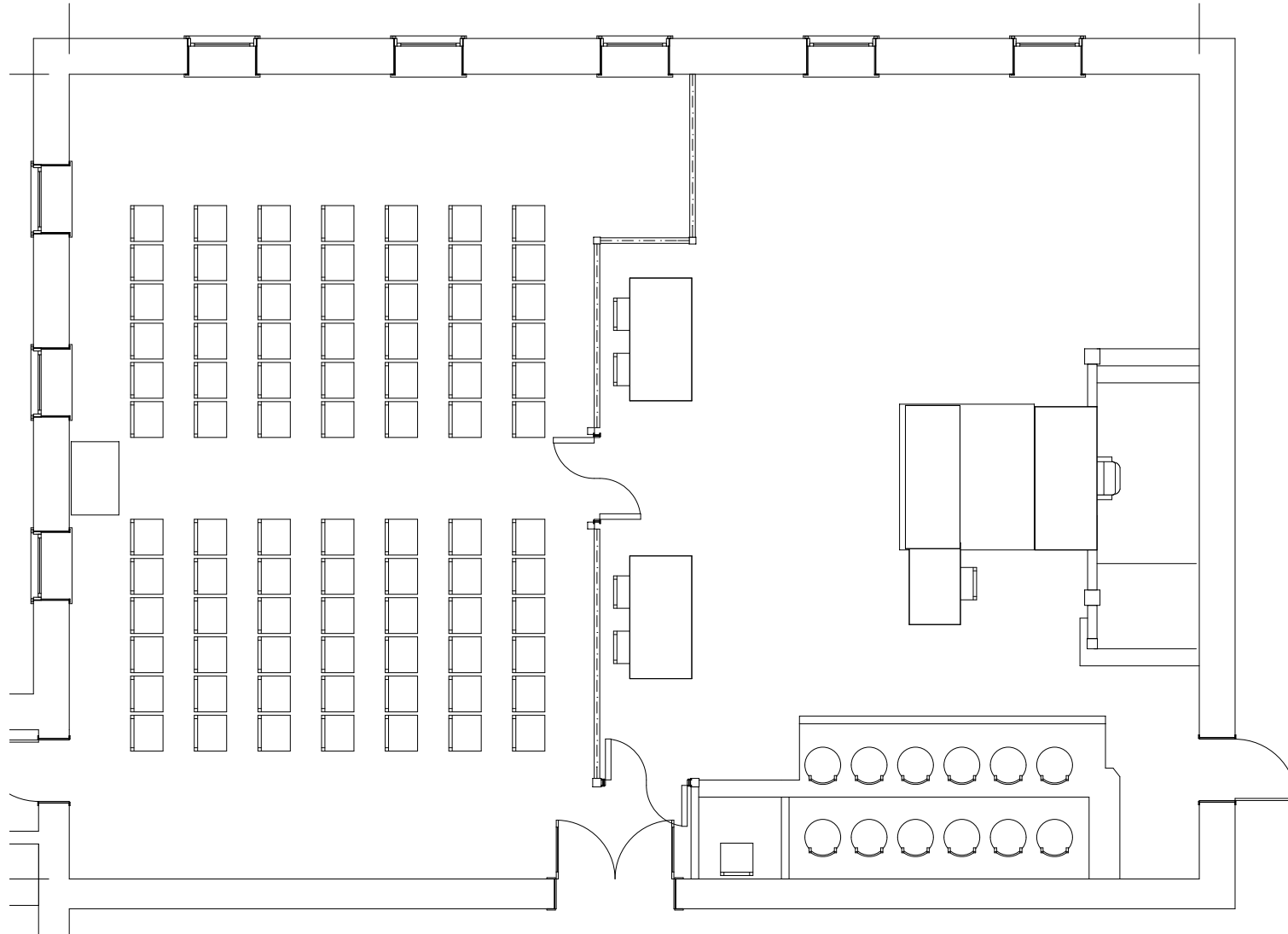

Scale: 3/16" = 1'-0
Square Footage: 2,1739
Date: August 6, 2011

Drawing by: JoshShade@gmail.com

Gallery Seating

Gallery Seating: 84

San Mateo County History Museum
2200 Broadway Street
Redwood City, CA 94063
(650) 299-0104

Courtroom A

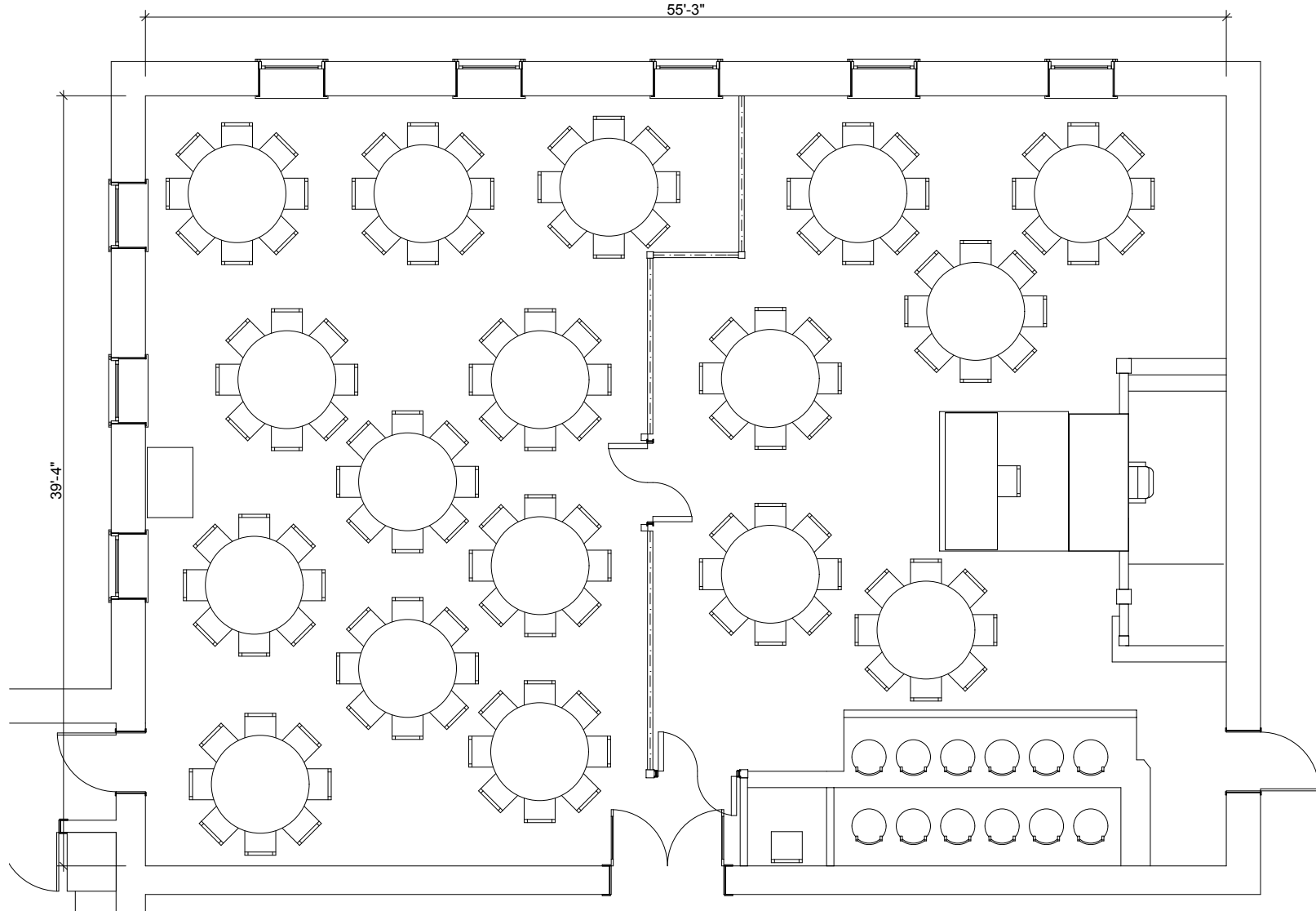

Scale: 3/16" = 1'-0"
Square Footage: 2,1739
Date: August 6, 2011

Drawing by: JoshShade@gmail.com

Banquet Seating

Maximum Seating:
8 @ each table = 136
10 @ each table = 150

San Mateo County History Museum
2200 Broadway Street
Redwood City, CA 94063
(650) 299-0104